



f. britsch

alles. immer. schnell.

VHM-BOHRSTANGEN- CARBIDE BORING BARS

IHR BEDARF – UNSERE LEIDENSCHAFT

BEI UNS BEKOMMEN SIE ALLES, WAS SIE
ZUM DREHEN BRAUCHEN

YOUR NEEDS – OUR PASSION

WITH US YOU GET ALL THE TOOLS THAT YOU
NEED FOR THE TURNED PARTS INDUSTRY

Bohrstangen aus Voll-Hartmetall (VHM)

Carbide Boring Bars

- VHM-Bohrstangen mit Wendeschneidplatten, zur Innen- und Außenbearbeitung
- höchste Maßgenauigkeit und beste Oberflächengüte
- durch die Ausführung in VHM und durch Kühlmittelbohrungen zur Innenkühlung speziell für tiefe Bohrungen, punktgenaue Kühlmittelzufuhr
- Bohr-Ø ab 5mm, Bohrtiefe bis 10 x D
- sehr gute Schwingungsdämpfung
- angeschliffene Fläche - kein Ausrichten erforderlich

- Carbide boring bars with inserts for internal and external machining
- Highest precision and surface quality
- Especially for deep bores
- Bore Ø >5mm, drilling depth until 10xD
- Very good vibration damping
- Ground flat - no adjusting required

Neue Kopfgeometrie
für erhöhte Steifigkeit und bessere Spanabfuhr

New Design for highest stiffness
and a better removal of chips

Stabilität und Präzision - *Stability and precision*

Neue Kopfgeometrie:
New geometry:

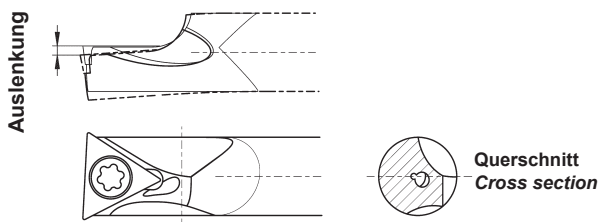

Höchste Steifigkeit durch Verkürzung des Lasthebels und günstigeres Biegeprofil
Highest stiffness as a result of a shorter load arm and a better profile

Herkömmliche Bohrstange:
Conventional boring bar:

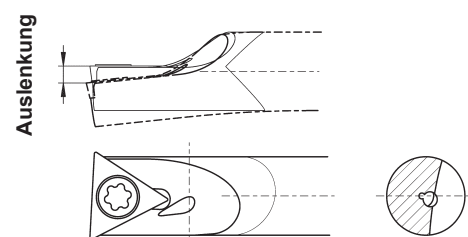

Oberflächenqualität und Sicherheit - *Surface quality and safety*

Neues Spankammerdesign
für verbesserte Spanabfuhr:
New chip space design for better removal of chips

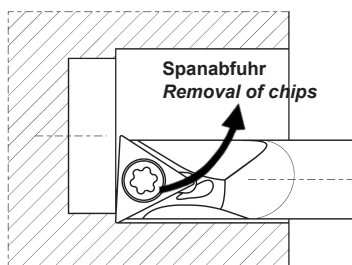

Ideale Spanabfuhr verbessert die Oberflächenqualität und reduziert den Werkzeugverschleiß
Perfect removal of chips effects a better surface quality and reduces tool wear

Herkömmliche Bohrstange:
Conventional boring bar

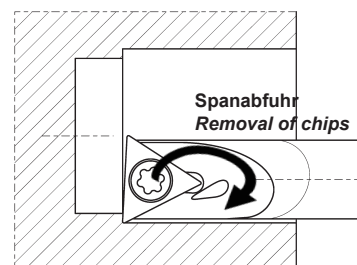

VHM - Bohrstangen
auch mit Innenkühlung, für höchste Präzision

Carbide Boring Bars
also with inner coolant for highest precision

Übersicht: Halter für Platten . . .

Overview: Holders for Inserts . . .

Platten - Inserts

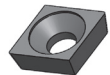

CC / CP . . 0301 / 0401 / 04T1 / 0602 / 09T3

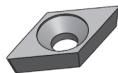

DC . . 0702 / 11T3

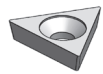

TC / TP / TB . . 0602 / 07T1 / 0802 / 0902 / 1102

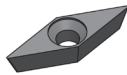

VC . . 0702



WB / WC . . 0601 / 0201

E...SCLC R/L ...SCLP R/L

Freiwinkel 7° **Clearance angle 7°**

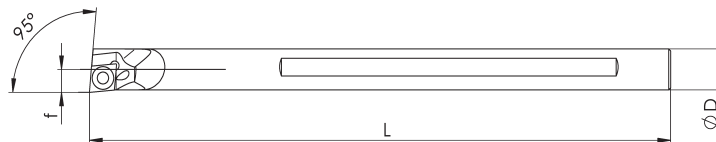
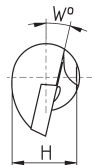
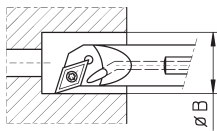

Bestell-Nr. order-no.	Platte insert	D	L	f	W [°]	H	Bmin	IK
BS-C04G-SCLCR/L03	CC... 0301	4	90	2,5		3,6	5	--
BS-C05H-SCLCR/L03	CC... 0301	5	100	3		4,5	6	--
BS-C06J-SCLCR/L04	CC... 0401	6	110	3,5		5,5	7	--*
BS-E06J-SCLPR/L04	CP... 04T1	6	110	3,5	7	5,5	7	X
BS-C07K-SCLCR/L04	CC... 0401	7	125	4		6,5	8	--*
BS-E08K-SCLPR/L04	CP... 04T1	8	125	4,5	7	7,5	9	X
BS-E08K-SCLCR/L06	CC... 0602	8	125	5,5		7,5	10	X
BS-E10K-SCLCR/L06	CC... 0602	10	125	5,5		9,5	11	X
BS-E10M-SCLCR/L06	CC... 0602	10	150	6,5	7	9,5	12	X
BS-E12M-SCLCR/L06	CC... 0602	12	150	6,5	7	11,5	13	X
BS-E12Q-SCLCR/L06	CC... 0602	12	180	7,5		11,5	14	X
BS-E12Q-SCLCR/L09	CC... 09T3	12	180	7,5		11,5	16	X
BS-E16R-SCLCR/L09	CC... 09T3	16	200	9	7	15,5	18	X
BS-E20R-SCLCR/L09	CC... 09T3	20	200	12,5	7	19,5	25	X
BS-E20S-SCLCR/L09	CC... 09T3	20	250	11		19,5	22	X

* mit innerer Kühlmittelzufuhr auf Anfrage

* with inner coolant on request



VHM - Bohrstangen
auch mit Innenkühlung, für höchste Präzision

Carbide Boring Bars
also with inner coolant for highest precision

E...SDQC R/L

Freiwinkel 7° *Clearance angle 7°*

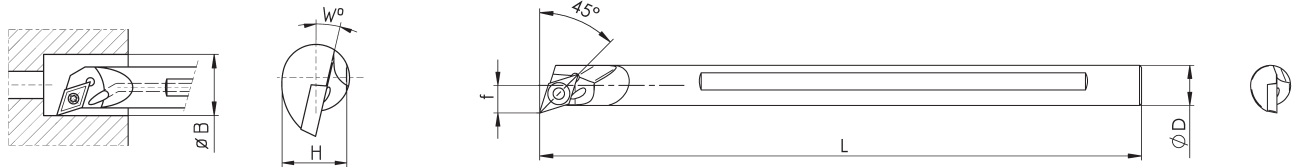

Bestell-Nr. order-no.	Platte insert	D	L	f	W [°]	H	Bmin	IK
BS-E0810K-SDQCR/L07	DC... 0702	10	125	7		9,5	13	X
BS-E10K-SDQCR/L07	DC... 0702	10	125	7		9,5	13	X
BS-E10M-SDQCR/L07	DC... 0702	10	150	7		9,5	13	X
BS-E12M-SDQCR/L07	DC... 0702	12	150	9		11,5	16	X
BS-E12Q-SDQCR/L07	DC... 0702	12	180	9		11,5	16	X
BS-E16R-SDQCR/L07	DC... 0702	16	200	11		15,5	20	X
BS-E16R-SDQCR/L11	DC... 11T3	16	200	11		15,5	21	X



E...SDUC R/L

Freiwinkel 7° *Clearance angle 7°*

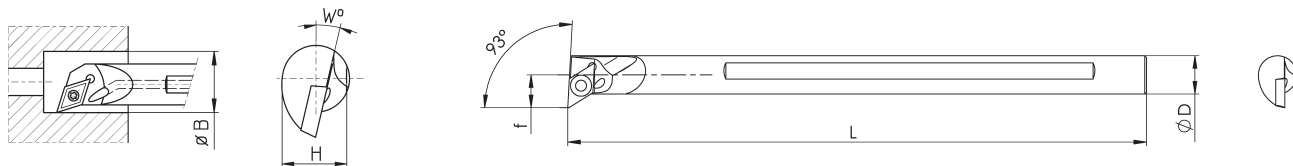

Bestell-Nr. order-no.	Platte insert	D	L	f	W [°]	H	Bmin	IK
BS-E08K-SDUCR/L07	DC... 0702	8	125	7,5		7,5	15	X
BS-E0810K-SDUCR/L07	DC... 0702	10 (8)	125	7,5	15	9,5	15	--*
BS-E10K-SDUCR/L07	DC... 0702	10	125	7		9,5	14	X
BS-E10M-SDUCR/L07	DC... 0702	10	150	8,5	13	9,5	17	X
BS-E10M-SDUCR/L07-F	DC... 0702	10	150	7		9,5	14	X
BS-E12M-SDUCR/L07	DC... 0702	12	150	9,5	10	11,5	19	X
BS-E12Q-SDUCR/L07	DC... 0702	12	180	9	10	11,5	18	X
BS-E16R-SDUCR/L07	DC... 0702	16	200	11,5		15,5	23	X
BS-E16R-SDUCR/L07-F	DC... 0702	16	200	11		15,5	22	X
BS-E16R-SDUCR/L011	DC... 11T3	16	200	11	10	15,5	23	X
BS-E20R-SDUCR/L011	DC... 11T3	20	200	14		19,5	26	X

* mit innerer Kühlmittelzufuhr auf Anfrage

* with inner coolant on request

VHM - Bohrstangen
auch mit Innenkühlung, für höchste Präzision

Carbide Boring Bars
also with inner coolant for highest precision

E...SDZC R/L

Freiwinkel 7° *Clearance angle 7°*

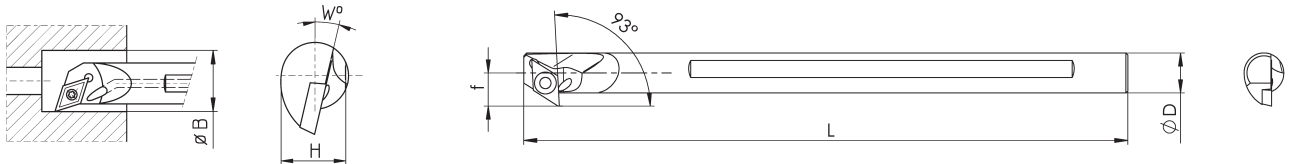

Bestell-Nr. order-no.	Platte insert	D	L	f	W [°]	H	Bmin	IK
BS-E08K-SDZCR/L07	DC... 0702	8	125	7,5	15	7,5	15	X
BS-E10M-SDZCR/L07	DC... 0702	10	150	8,5	13	9,5	17	X
BS-E12M-SDZCR/L07	DC... 0702	12	150	9,5	10	11,5	19	X
BS-E16R-SDZCR/L07	DC... 0702	16	200	11,5	10	15,5	23	X

E...STFC R/L

Freiwinkel 7° *Clearance angle 7°*

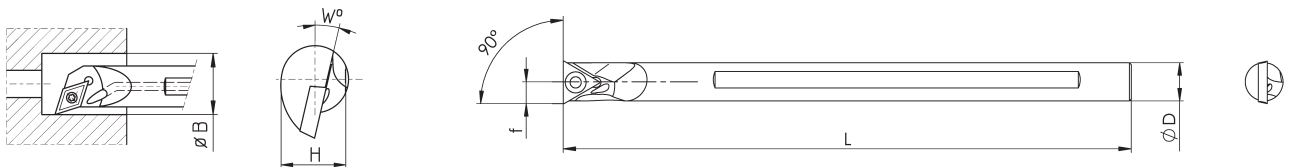

Bestell-Nr. order-no.	Platte insert	D	L	f	W [°]	H	Bmin	IK
BS-E08K-STFCR/L09	TC... 0902	8	125	5,5		7,5	10	X
BS-E10M-STFCR/L09	TC... 0902	10	150	6,5		9,5	12	X

E...STFP R/L

Freiwinkel 11° *Clearance angle 11°*

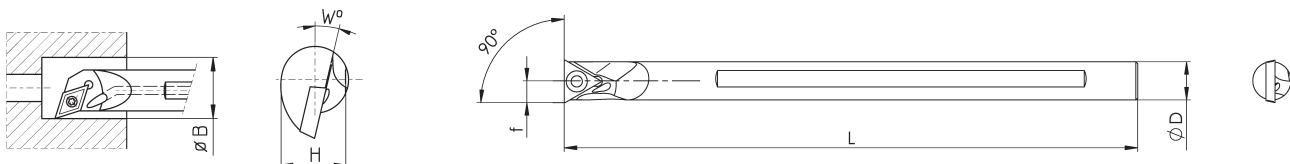

Bestell-Nr. order-no.	Platte insert	D	L	f	W [°]	H	Bmin	IK
BS-E08K-STFPR/L08	TP... 0802	8	125	5		7,5	10	X
BS-E10K-STFPR/L09	TP... 0902	10	150	6		9,5	12	X

VHM - Bohrstangen
auch mit Innenkühlung, für höchste Präzision

Carbide Boring Bars
also with inner coolant for highest precision

E...STUB R/L

Freiwinkel 5° Clearance angle 5°

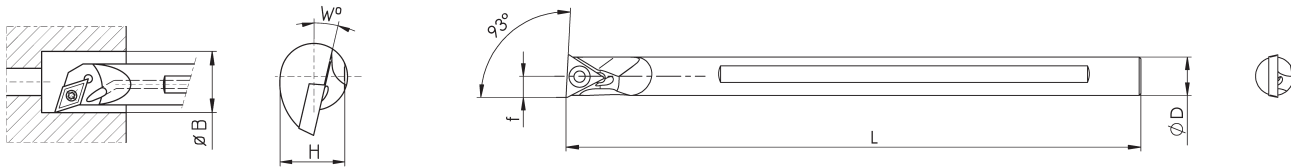

Bestell-Nr. order-no.	Platte insert	D	L	f	W [°]	H	Bmin	IK
BS-C06J-STUBR/L06	TB...0602	6	110	4		5,5	8	--

* mit innerer Kühlmittelzufuhr auf Anfrage

* with inner coolant on request

E...STUC R/L ...STUP R/L

Freiwinkel 7° Clearance angle 7°

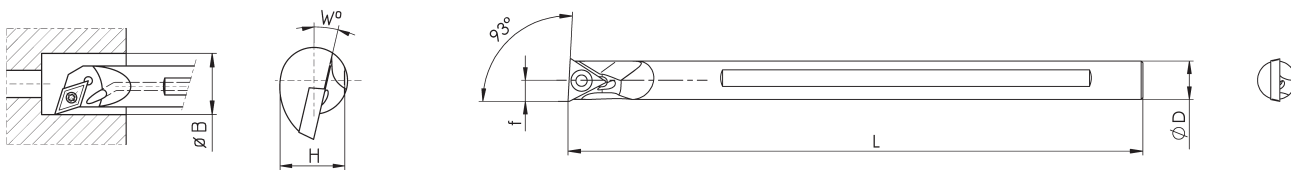

Bestell-Nr. order-no.	Platte insert	D	L	f	W [°]	H	Bmin	IK
BS-E06J-STUPR/L07	TP... 07T1	6	110	3,6	7	5,5	7,2	X
BS-E08K-STUPR/L07	TP... 07T1	8	125	4,6	7	7,5	9,2	X
BS-E08K-STUPR/L09	TC... 0902	8	125	5,5		7,5	10	X
BS-E10K-STUCR/L09	TC... 0902	10	125	6,5		9,5	12	X
BS-E10M-STUCR/L11	TC... 1102	10	150	5,5	7	9,5	11,2	X
BS-E12M-STUCR/L11	TC... 1102	12	150	6,5	7	11,5	13,2	X
BS-E16R-STUCR/L11	TC... 1102	16	200	8,5	7	15,5	17,2	X

E...SVLC R/L

Freiwinkel 7° Clearance angle 7°

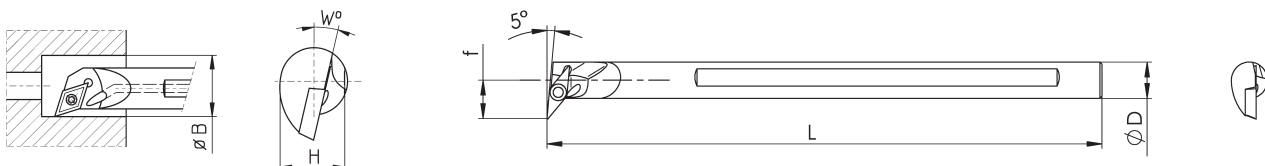

Bestell-Nr. order-no.	Platte insert	D	L	f	W [°]	H	Bmin	IK
BS-E08K-SVLCR/L07	VC.. 0702	8	125	10	10	7,5	13	X
BS-E10M-SVLCR/L07	VC.. 0702	10	150	8	8	9,5	15	X
BS-E12M-SVLCR/L07	VC.. 0702	12	150	6	6	11,5	17	X

VHM - Bohrstangen
auch mit Innenkühlung, für höchste Präzision

Carbide Boring Bars
also with inner coolant for highest precision

E...SVOC R/L

Freiwinkel 7° *Clearance angle 7°*

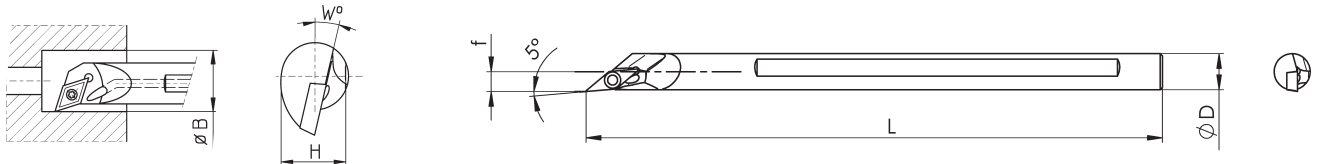

Bestell-Nr. order-no.	Platte insert	D	L	f	W [°]	H	Bmin	IK
BS-E08K-SVOCR/L07	VC.. 0702	8	125	10	10	7,5	9	X
BS-E10M-SVOCR/L07	VC.. 0702	10	150	8	8	9,5	11	X
BS-E12M-SVOCR/L07	VC.. 0702	12	150	6	6	11,5	13	X

E...SVVC R/L

Freiwinkel 7° *Clearance angle 7°*

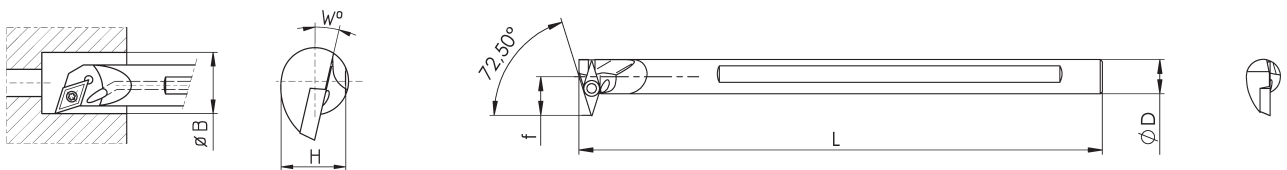

Bestell-Nr. order-no.	Platte insert	D	L	f	W [°]	H	Bmin	IK
BS-E08K-SVVCR/L07	VC.. 0702	8	125	10	10	7,5	13,5	X
BS-E10M-SVVCR/L07	VC.. 0702	10	150	8	8	9,5	15,5	X
BS-E12M-SVVCR/L07	VC.. 0702	12	150	6	6	11,5	17,5	X

E...SVXC R/L

Freiwinkel 7° *Clearance angle 7°*

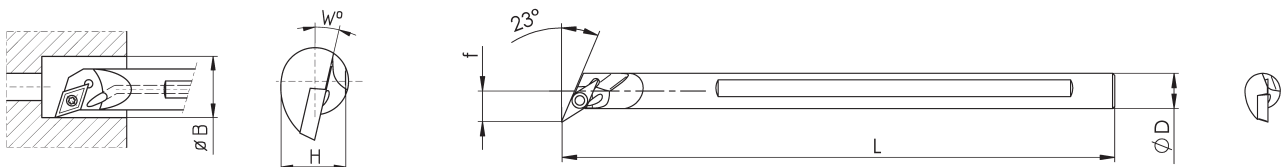

Bestell-Nr. order-no.	Platte insert	D	L	f	W [°]	H	Bmin	IK
BS-E08K-SVXCR/L07	VC.. 0702	8	125	10	10	7,5	11,5	X
BS-E10M-SVXCR/L07	VC.. 0702	10	150	8	8	9,5	13,5	X
BS-E12M-SVXCR/L07	VC.. 0702	12	150	6	6	11,5	15,5	X

VHM - Bohrstangen
auch mit Innenkühlung, für höchste Präzision

Carbide Boring Bars
also with inner coolant for highest precision

E...SVZC R/L

Freiwinkel 7° Clearance angle 7°

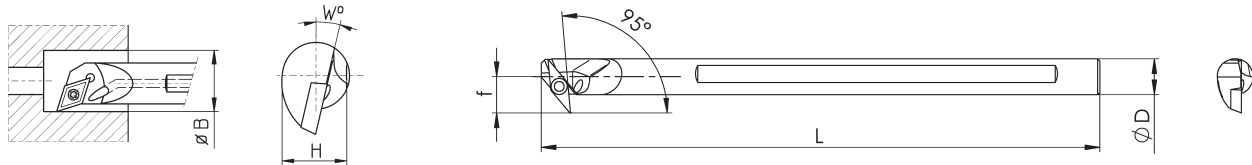

Bestell-Nr. order-no.	Platte insert	D	L	f	W [°]	H	Bmin	IK
BS-E08K-SVZCR/L07	VC.. 0702	8	125	10	10	7,5	12,5	X
BS-E10M-SVZCR/L07	VC.. 0702	10	150	8	8	9,5	14,5	X
BS-E12M-SVZCR/L07	VC.. 0702	12	150	6	6	11,5	16,5	X

E...SWUB R/L

Freiwinkel 5° Clearance angle 5°

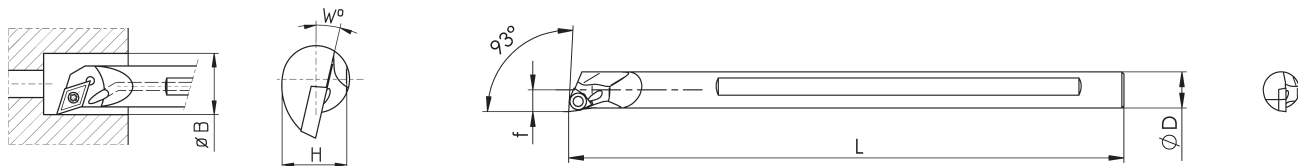

Bestell-Nr. order-no.	Platte insert	D	L	f	W [°]	H	Bmin	IK
BS-E05F-SWUBR/L06	WBG 0601	5	80	3		4,5	5,5	X
BS-E06F-SWUBR/L06	WBG 0601	6	80	3,5		5,5		X
BS-E07K-SWUBR/L06	WBG 0601	7	125	4		6,5		X
BS-E08K-SWUBR/L06	WBG 0601	8	125	4,5		6,5		X

E...SWUC R/L

Freiwinkel 7° Clearance angle 7°

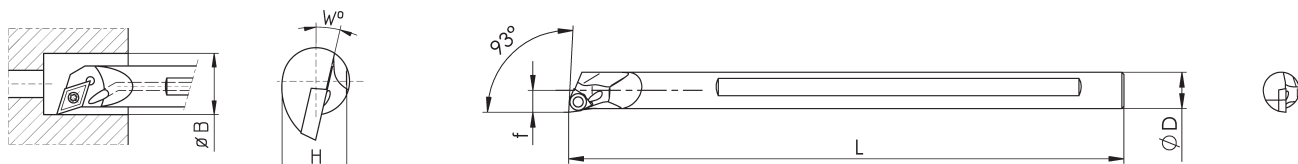

Bestell-Nr. order-no.	Platte insert	D	L	f	W [°]	H	Bmin	IK
BS-E06J-SWUCR/L02	WCGX 0201	6	110	3,9	17	5,5	7,8	X
BS-E08K-SWUCR/L02	WCGX 0201	8	125	4,9	12	7,5	9,8	X
BS-E10M-SWUCR/L02	WCGX 0201	10	150	5,9	12	9,5	11,8	X